





# Level 2 CRT Scenarios

- 

Transportation Demand Mgmt.  
Transportation System Mgmt.
- 

Eight General Purpose Lanes
- 

I-287 Programmed Improvements  
Safety and Operational Improvements at Selected Locations in Westchester County
- 

Bus Rapid Transit High Occupancy Toll
- 

Commuter Rail Transit
- 

Maintain Bridge  
• Repairs as needed  
• Continuous Maintenance
- 

Replacement Bridge
- 

Parkway with Pedestrian and Bikeway Promenade
- 

Westbound Climbing Lane
- 

Six General Purpose Lanes, One Reversible Lane
- 

Bus Rapid Transit
- 

Light Rail Transit
- 

Rehabilitate Bridge  
• Seismic Retrofitting  
• Upgrade to Current Standards  
• Reduce Vulnerability
- 

Tunnel

## CRT1

Replacement Bridge with Full Corridor Commuter Rail

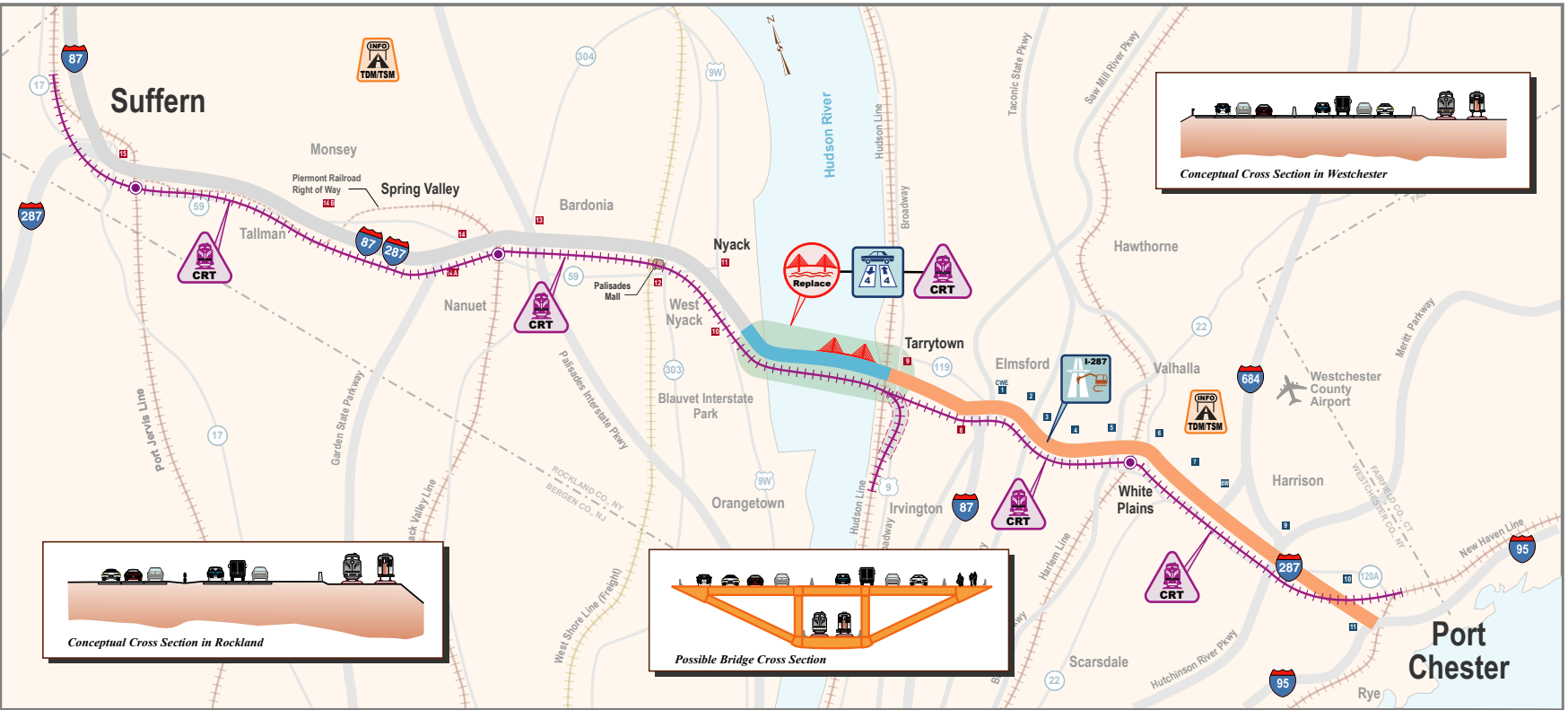

## CRT2

Rehabilitate Tappan Zee Bridge with Supplemental Commuter Rail Tunnel

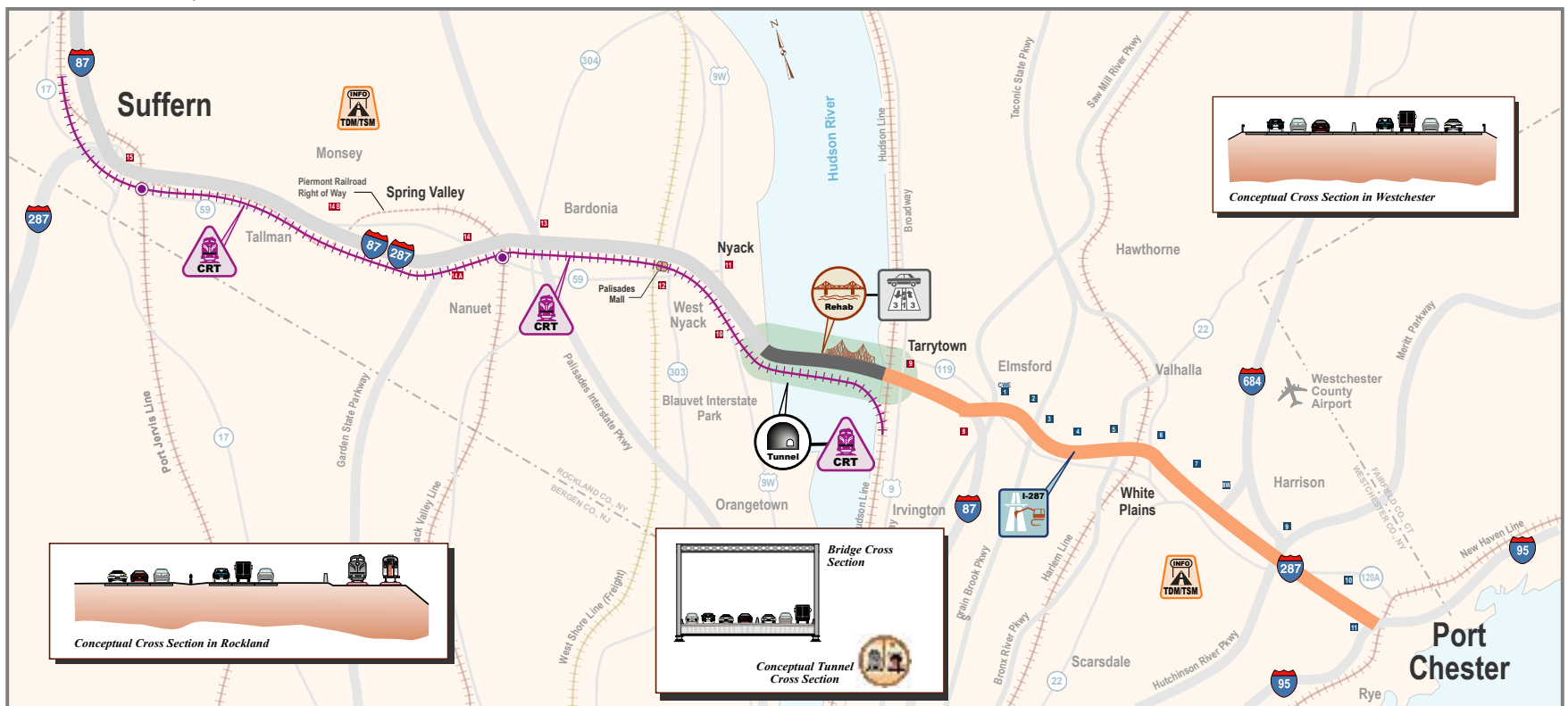

## CRT3

Replacement Bridge with Circumferential Commuter Rail

